



HMO in YO11

Grosvenor Crescent, Scarborough, North Yorkshire, YO11 2LJ

£325,000 Starting Bid

Allocated parking

Property features

- ✓ 10 bedroom block
- ✓ Private garden
- ✓ Storage cupboards
- ✓ Two communal kitchens
- ✓ En-suites

Description

For sale via secure sale online bidding - terms and conditions apply.

We are delighted to offer this 10 Bedroom HMO BLOCK generating just over £51,000 per annum with tenants in situ.

This block contains 10 separate rooms with en-suites, two shared kitchens and a shared garden to the rear.

Please note we have not inspected this property.

Price: Starting Bid £325,000

Property Type: HMO

Business Type: Residential Investments

Parking: Allocated

Location

Situated in Scarborough, North Yorkshire. This property is located close to many local amenities such as shops and entertainment facilities. A short walk away is Scarborough beach. Also, there is transport links as Scarborough rail station is a short distance from the properties location.

Accommodation

Lower Ground Floor

On the lower ground floor we have the two communal kitchens, a utility room with washing machine and tumble dryer on coin meters, access to the rear yard and one room with en-suit

Ground Floor

This large entrance hallway you have access to both stairs down and up, one room with separate bathroom and other with en-suit with shower.

First Floor

This floor had storage cupboards in the hallway, two rooms with shower rooms/bathroom and another room with shower over bath

Top Floor

The top ceiling has stained glass skylight and split into four rooms, two with shower in the bedroom and small WC, two other with shower room/WC together with some great views of Scarborough out the window

Council tax

Band C

EPC

Available upon request (rating C)

Additional information

For further information please contact our office directly on 0191 737 1154, or alternatively via email on commercial@pattinson.co.uk. With regards to viewing subject property, this is to be done strictly by appointment.

▼ **Basement**

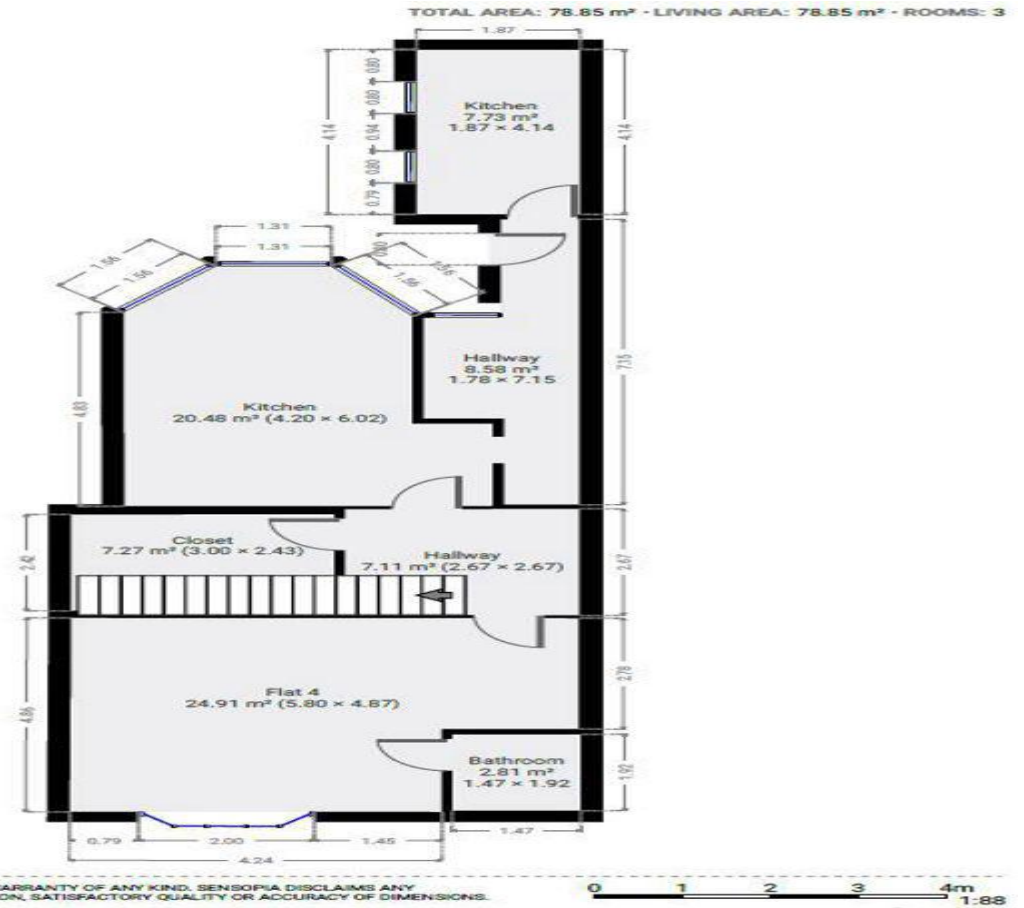

Grosvenor Crescent, Scarborough, North Yorkshire, YO11 2LJ

Contact your local branch today for more information on this property:

19 Cleeve Wood Road, Bristol, Gloucestershire, BS16 2SF, <http://www.mcoleman.co.uk/>

These particulars, whilst believed to be accurate are set out as a general outline only for guidance and do not constitute any part of an offer or contract. Intending purchasers should not rely on them as statements of representation of fact, but must satisfy themselves by inspection or otherwise as to their accuracy. No person in this firm's employment has the authority to make or give any representation or warranty in respect of the property.

